

## EBDMR-DALI2 | DALI-2, input device, mid-range, occupancy and lux level PIR presence detector



Part of our mid-range, ceiling, flush mounted detectors. A superior detection pattern using a high performance faceted lens suitable for use in open spaces or where a larger detection range is required.

### Key Product Features:

- DALI-2 certified
- Multi-master input device
- Fully compliant to IEC 62386-303 (Occupancy detector) and IEC62386-304 (Light Level detection)
- Fully compatible with other DALI-2 application controller
- Wide detection ideal for open work spaces
- IP40 rated

### Detection pattern

high < sensitivity > low

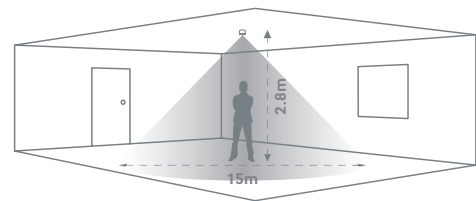

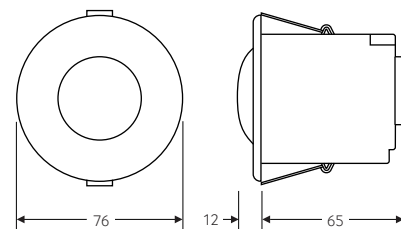

### Dimensions (mm)



## Technical Data

<b>Part Code</b>	<b>EBDMR-DALI2</b>
<b>Weight</b>	0.15kg
<b>Supply voltage DC</b>	9.5–22.5 VDC DALI bus
<b>Nominal Current Consumption</b>	8mA
<b>Max (Peak) Current Consumption</b>	18mA
<b>Terminal capacity</b>	2.5mm <sup>2</sup>
<b>Rated impulse voltage</b>	2500V
<b>Purpose</b>	Sensing control
<b>Construction</b>	Independent flush mounted, electronic control
<b>Type of action</b>	Type 1.B action (micro disconnection)
<b>Operating temperature</b>	-10°C to +35°C
<b>Humidity</b>	5 to 95% non-condensing
<b>Pollution</b>	Degree 2
<b>Software</b>	Class A
<b>Material (casing)</b>	Flame retardant ABS and PC/ABS
<b>DALI-2 Certification</b>	IEC62386 Parts 101,103, 303 & 304
<b>Compliance</b>	<b>CE UK CA</b>

## Accessories and Associated Products

Part Number	Description
 EXD-HSC	Extended wiring housing
 DBB	Surface mounting box
 DBB-EXT	Surface mount back box extender



**CP Electronics**  
A brand of **legrand**

Great King Street North  
Birmingham  
B19 2LF

+44 (0)333 900 0671  
customerservice.cpelectronics@legrand.com  
legrand.co.uk/en/brands/cp-electronics

connect with us